

## Lens Mirrors

The traffic safety mirror is used to provide control and safety to the drivers at the car park entrance exits and at the blind spots where the oncoming vehicle does not appear. With its robust structure, it is resistant to harsh climatic conditions. Manufactured as resistant to impacts from acrylic material.

### Hat

It is designed to provide protection against weather conditions.  
(Only CM-300 model is without hat.)

### Plastic Material

Made of plastic material with high impact resistance and outdoor weather conditions.

### Acrylic Lens

Durable and reflective feature provides the user with clarity.



## Technical Specifications

Material	Plastic
Color	Orange
Mirror	2mm Acrylic
Dimensions and Codes	CM-300 (Ø 300mm) For indoor use without hats. CM-450 (Ø 450mm) CM-600 (Ø 600mm) CM-800 (Ø 800mm) CM-1000 (Ø 1000mm) CM-1200 (Ø 1200mm)

# STARLINE

## Material information

### ACRYLIC:

Acrylic material consisting of natural minerals is used to provide long-lasting usage thanks to its strong structure. So once you get the product you can use for many years. Acrylic material is used instead of glass in Starline lens mirrors. In case of breaking of acrylic mirrors, it is safer than glass pieces.

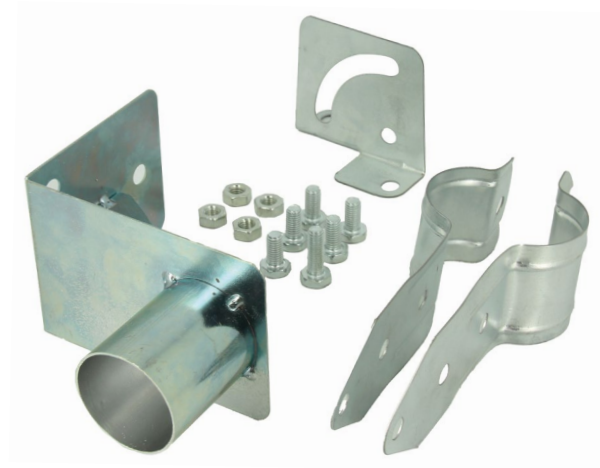

\* **STARLINE** lens mirrors are supplied with mounting equipment that connects to the pole.

## Order Information

MODEL	Ø Diameter	Color	Barcode	Box Dimension	Box Weight
CM-300	300mm	Orange	8680907942096	32 x 32 x 7cm	0.9 kg
CM-450	450mm	Orange	8680907942102	45 x 51 x 11cm	2.2 kg
CM-600	600mm	Orange	8680907942119	64 x 62 x 12cm	3.0 kg
CM-800	800mm	Orange	8680907942126	84 x 85 x 14cm	5.5 kg
CM-1000	1000mm	Orange	8680907942133	100 x 100 x 14.5cm	8.0 kg
CM-1200	1200mm	Orange	8680907942140	122 x 123 x 19cm	11.0 kg

Each product is sold in single packages.